

# HW 161 N

180 Watt max

8 Ω

Ø 160 mm / 6"

4 Ω  CAR CW 161N

## WOOFER

Membrana in cellulosa smorzata e sospensione in gomma

Doped paper cone, rubber surround

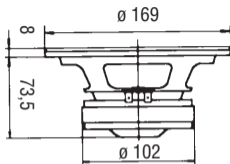

Potenza nominale **80 W**

Impedenza nominale **8 Ω**

Sensibilità (1W/1m) **90 dB**

Ø bobina mobile **32 mm**

Altezza traferro **6 mm**

Fori di fissaggio **4  $\varnothing$ 5 /  $\varnothing$ 158**

Foro pannello **142 mm**

Re **6,1 Ω**

Fs **47,42 Hz**

Qms **2,01**

Qes **0,46**

Qts **0,37**

Mms **13,99 g**

Cms **0,81 mm/N**

D **130 mm**

Vas **19,92 dm<sup>3</sup>**

Bxl **7,42 Wb/m**

Xmax **3 mm**

$\eta^\circ$  **0,45 %**

Le **0,69 mH**

Peso **1,4 Kg**

