

# CS 201

**180+180 Watt max**    **4+4 Ω**

**Ø 200 mm / 8"**

## SUB WOOFER

Doppia bobina mobile,  
membrana in cellulosa smorzata  
e sospensione in gomma

Dual coil, doped paper cone,  
rubber surround

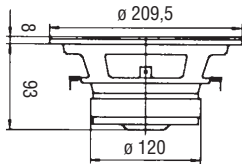

Potenza nominale	<b>60+60 W</b>
Impedenza nominale	<b>4+4 Ω</b>
Sensibilità (1W/1m)	<b>90 dB</b>
Ø bobina mobile	<b>38 mm</b>
Altezza traferro	<b>6 mm</b>
Fori di fissaggio	<b>4 Ø5/Ø 198,5</b>
Foro pannello	<b>180 mm</b>

Re	<b>3+3 Ω</b>	D	<b>168 mm</b>
Fs	<b>43 Hz</b>	Vas	<b>44 dm³</b>
Qms	<b>3,25</b>	BxI	<b>3,85 Wb/m</b>
Qes	<b>0,58</b>	Xmax	<b>4 mm</b>
Qts	<b>0,49</b>	η°	<b>0,58 %</b>
Mms	<b>21 g</b>	Le	<b>0,2 mH</b>
Cms	<b>0,64 mm/N</b>	Peso	<b>2,4 Kg</b>

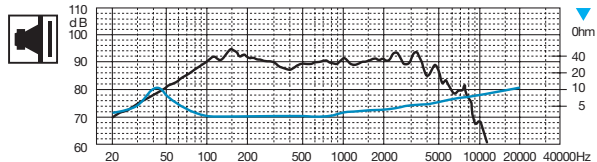

Parametri rilevati con bobine mobili in parallelo

Parameters taken with coils in parallel