

## TWEETER

### CT 200

100 Watt max 4 Ω

Ø 20 mm

8 Ω  HOME HT200

TWEETER

Soft dome in poliammide

4 Ω Polyamide soft dome

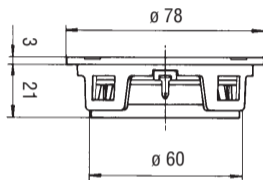

Potenza nominale	<b>60 W</b>	Re	<b>3 Ω</b>	D	<b>23 mm</b>
Impedenza nominale	<b>4 Ω</b>	Fs	<b>1 kHz</b>	Vas	
Sensibilità (1W/1m)	<b>90 dB</b>	Qms	<b>4,7</b>	BxI	<b>2,17</b>
Ø bobina mobile	<b>20 mm</b>	Qes	<b>1,1</b>	Xmax	<b>Wb/m</b>
Altezza traferro	<b>2 mm</b>	Qts	<b>0,9</b>	η°	
Fori di fissaggio	<b>4 Ø4 / Ø 81</b>	Mms	<b>0,28 g</b>	Le	
Foro pannello	<b>70 mm</b>	Cms		Peso	<b>0,02 mH</b>

