

CZ 140

90 Watt max

4 Ω

ellittico 150x96 mm / 6"x4"

COASSIALI

2 Vie coassiali, membrana woofer in cellulosa smorzata, tweeter in neodimio

2 Way coax, doped paper cone, neodymium tweeter

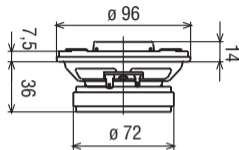

Potenza nominale **40 W**

Impedenza nominale **4 Ω**

Sensibilità (1W/1m) **92 dB**

Ø bobina mobile **25 mm**

Altezza traferro **4 mm**

Fori di fissaggio **4 $\varnothing 5$ ■ 73x123**

Foro pannello **ell. 144x87mm**

Re **3,5 Ω**

Fs **159 Hz**

Qms **6,80**

Qes **1,73**

Qts **1,38**

Mms **3,63 g**

Cms **0,28 mm/N**

D **99 mm**

Vas **2,29 dm³**

B×l **2,71 Wb/m**

Xmax **1,1 mm**

η°

Le

Peso **0,48 Kg**