

# CS 200

120+120 Watt max 4+4 Ω

Ø 200 mm / 8"

## SUB WOOFER

Doppia bobina mobile, membrana in cellulosa smorzata e sospensione in poliuretano

Dual coil, doped paper cone, polyurethane surround

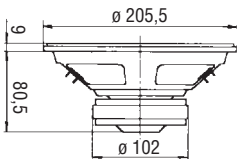

Potenza nominale **40+40 W**

Impedenza nominale **4+4 Ω**

Sensibilità (1W/1m) **90 dB**

Ø bobina mobile **32 mm**

Altezza traferro **6 mm**

Fori di fissaggio **4 Ø5,5 / Ø194**

Foro pannello **185 mm**

Re **2,8+2,8 Ω**

Fs **50 Hz**

Qms **3,27**

Qes **0,79**

Qts **0,64**

Mms **16 g**

Cms **0,63 mm/N**

D **165 mm**

Vas **40 dm<sup>3</sup>**

B×l **3,05 Wb/m**

Xmax **5 mm**

η° **0,61 %**

Le **0,18 mH**

Peso **1,47 Kg**

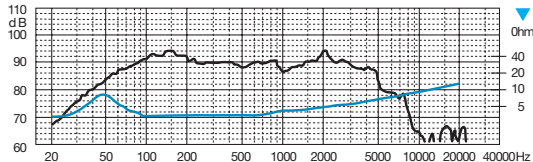

Parametri rilevati con bobine mobili in parallelo

Parameters taken with coils in parallel