

## TWEETER

**CT 262**

▶ **200 Watt max**  $4 \Omega$   
**Ø 26 mm / 1"**

▶ **8  $\Omega$  HOME HT262**

■ **WOOFER**

■ Soft dome in seta

■ Silk soft dome

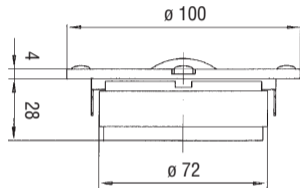

Potenza nominale	<b>100 W</b>	Re	<b>3,25 <math>\Omega</math></b>	D	<b>32 mm</b>
Impedenza nominale	<b>4 <math>\Omega</math></b>	Fs	<b>1 kHz</b>	Vas	
Sensibilità (1W/1m)	<b>90 dB</b>	Qms	<b>3,5</b>	BxI	<b>2,5 Wb/m</b>
Ø bobina mobile	<b>26 mm</b>	Qes	<b>1,14</b>	Xmax	
Altezza traferro	<b>3 mm</b>	Qts	<b>0,86</b>	$\eta^\circ$	
Fori di fissaggio	<b>4 <math>\varnothing 5 / \varnothing 88</math></b>	Mms	<b>0,35 g</b>	Le	<b>0,03 mH</b>
Foro pannello	<b>75 mm</b>	Cms		Peso	<b>0,63 Kg</b>

